

M/V ORLOVA



VESSEL
INFORMATION



THE POLAR
CRUISE EXPERTS
www.quarkexpeditions.com



M/V ORLOVA

Shipboard Information

M/V ORLOVA

The M/V Orlova was built in former Yugoslavia in 1975 and is one of six vessels of this class. This spacious, comfortable ice-strengthened motor vessel carries a maximum of 110 passengers and has passive stabilizers for smooth sailing.

ANNOUNCEMENTS

All announcements while on board will be made in English and will be relayed over the public address system including wildlife sightings, disembarkation announcements and itinerary and weather updates.

BAR & WINE SERVICE

There is a well stocked bar on board, staffed by a European bartender, in the late morning, afternoon and evening. All drinks, liquors, spirits and beverages are imported through international ship's chandlers - and every effort is made to maintain reasonable prices. A varied list of good wine and champagne will be available in the dining room and bar.

BRIDGE VISITS

Passengers are welcome to visit the Bridge at anytime unless asked to leave by the Captain or officers especially during bad weather. This is an excellent place to watch ship operations and maintain a lookout for wildlife. To enable our officers to navigate the ship, we ask that passengers stay clear of the working areas and do not eat or drink.

BRIEFINGS/RECAPS /LECTURES

Regular sessions will be scheduled when the Expedition Leader and staff will update passengers on plans and provide information about landings. Recap sessions offer an opportunity for passengers to recount their experiences ashore and question the staff.

A unique lecture series by our diverse team of outstanding expedition staff will be provided. This may include slide-illustrated presentations, videos and other educational programs. An extensive lecture series will cover all features of our voyage and on the surrounding environment. Video programs will include documentary and general entertainment films.

CABINS

All cabins are outside, with private facilities; twins have 2 lower fixed berths and triples have 2 lower fixed berths as well as 1 upper berth. Captain's Deck twin cabins (Deck 6) have one square window that opens and one fixed window. The Amundsen Suites on Deck 5, cabins 501 and 502, have a separate living room with a sectional couch and two square windows that open along with two fixed portholes and VCR and monitor. Superior cabin 503 has a sectional couch and three square windows that open plus one fixed porthole and TV monitor. Cabins 501, 502 and 503 on Deck 5 all open onto a promenade which has glass windows to the outside. Superior cabins 505 and 506 have one square window that opens and one fixed porthole plus a TV monitor, and open into Deck 5 hallway. Cabins on Deck 3 have non-opening portholes. There is also a centralized VCR station located in the Hotel Manager's office from which videos are piped into the suites and lounge/bar.

All cabin floors are carpeted. Each cabin has a loudspeaker for general announcements and music piped in from the radio room. Hairdryers, quality soap and shower gel are available in each cabin.

All passengers will receive a robe for use whilst onboard which will be collected on the last day of the voyage. These are available for purchase if passengers wish to take one home.



| |
|--|
| CABIN SERVICE |
| CABIN TEMPERATURE CLIMATE CONTROL |
| COMMUNICATION |
| DAILY PROGRAM |
| DRESS ON BOARD |
| ELECTRIC CURRENT |
| ELEVATOR |
| ENGINE ROOM VISITS |
| EXERCISE ROOM |
| FACILITIES |
| GRATUITIES |
| HAIRDRESSER |

All cabins will be cleaned on a daily basis by the Russian stewardesses. Towels will be changed as desired but, for environmental reasons, we ask passengers to change towels only if necessary. Bed sheets will be changed every third day. There is no cabin food or drink service available.

In some cabins the windows may be opened for fresh air. In addition, passengers may control the flow of warm air into the cabin by adjusting the vent. If passengers do open their window/porthole, they must remember to close it before they leave the cabin. As throughout the vessel, the average temperature in your cabin is approximately 70°F to 75°F or 21°C to 24°C.

The vessel (radio room) is equipped with both direct satellite M phone, facsimile and email systems (for TEXT messages only). Full details on contacting the ship will be included in passengers' final documents. Although very reliable, charges for telephone calls are quite expensive - US\$3.50 per minute. Email charges are approx. US\$5.00 for half an A4 letter size page for both incoming and outgoing messages. At some latitudes, service may be temporarily unavailable. The radio officer answers all incoming calls and receives and distributes any fax messages. In general, passengers receiving calls/messages will be paged and the caller is often requested to call back at a time when they are aboard.

A daily program or itinerary is published each evening and distributed to cabins. It lists lectures, meal hours and all planned activities.

In keeping with our expedition atmosphere, the dress code on board stresses informality. Passengers should plan to bring comfortable, casual clothing for all inside activities. Gentlemen may wish to bring a coat and tie, and ladies a cocktail dress for the Captain's Welcome and Farewell parties but this is certainly not necessary.

The electrical supply on board is 220 volts, 50 hertz. The electrical outlet sockets are the standard European two round pin system. Passengers coming from countries with a different system will need to bring a suitable adapter.

There is NO elevator aboard this vessel.

Engine room visits are NOT allowed.

The vessel has limited exercise equipment on board for your use.

Spacious forward lounge and bar, a window lined dining room, an infirmary, exercise room and a well-stocked library.

As the customary gratuity to the ship's personnel is divided amongst the entire crew/hotel staff, the following is suggested as a guideline for our passengers convenience: we suggest US\$9 to US\$11.00 per person, per day. As stated, this is only a guideline and the amount passengers wish to give is at their discretion and can be added to their shipboard account.

There is no hairdresser on board and ladies should come prepared to do their own. There are hairdryers in each cabin.



HOTEL DEPARTMENT

Our highly experienced, European Hotel Manager is responsible for all passenger services and administrative matters while on board, as well as for shipboard accounts. The Hotel Manager has regular office hours, which will be posted and listed in the daily program.

The Hotel Manager also supervises the catering personnel - a combination of international staff and Russian crew. Our team of chefs, dining room staff and bartender are mostly of Austrian, German and Scandinavian descent. Most have worked for us for many seasons.

LAUNDRY

Laundry service will be available, similar to that of a hotel, provided by the cabin stewardesses. Laundry request forms and bags will be in each cabin and laundry is collected each morning. Generally it will be returned in 48 hours. Average prices: Men's shirts/sweaters, US\$2.50 - 3.00, Women's blouses/slacks, US\$3.00. A complete laundry list with prices will be provided on board. Ironing services are also available at a minimal charge. There are no facilities for dry cleaning or a self-service laundry.

LIBRARY

There is a small library on board that has a selection of polar books, reference materials and general reading material along with board games and playing cards.

LIFE BOAT DRILL

By international law, passengers must participate in an emergency exercise within 24-hours of sailing. Upon embarkation, passengers will be requested to locate their life vest in their cabin and note their life boat and muster station. This mandatory life boat drill will be scheduled as soon as convenient by the Expedition Leader.

MAIL

Mail may be posted from the ship and will be charged to passengers individual shipboard accounts. The cabin number and name should be clearly noted in the upper right hand corner of each card or letter when deposited. Please take note that few of the ports we visit accept mail - and delivery can be quite slow and erratic.

MEAL SERVICE

There is one large dining room on board that seats everyone at one sitting. Seating is not reserved and we encourage passengers to sit where and with whom they like. Hours will be posted in the daily program. Breakfast is served buffet style with table service. There is a choice of main course from the menu at lunch and dinner featuring international cuisine prepared by international chefs. Coffee and tea are available all day and mid-afternoon snacks and cakes are served between 4:00 p.m. and 5:00 p.m. daily. Service aboard all our vessels is personal - a combination of international staff and experienced Russian crew. Should passengers have any special dietary requirements, we request that they inform us as far in advance of their voyage as possible so the necessary arrangements can be made. The kitchen is not set up for Kosher meal preparation.

MEDICAL FACILITIES

The vessel has a well equipped medical clinic with an adequate supply of western medicines and equipment. There will be a Western physician on board. We cannot guarantee to have every drug or piece of equipment for every medical problem. If passengers are under regular treatment for any ailment, they must bring a more than adequate supply of medicines for the duration of their voyage. We cannot accept responsibility for not having a specific brand or type of drug on board. If passengers suffer from any potentially serious illness, they should inform us prior to the voyage so that we can alert the doctor to their condition.



NAME BADGES

A name badge will be sent to passengers along with their final documents. We encourage them to wear this so our staff and fellow passengers can get to know them better.

OFFICERS AND CREW

The Russian Captain, officers and crew speak basic English. All are experienced in ice operations and navigation under severe conditions in the Russian Arctic.

PAYMENT SYSTEM

Upon embarkation, an account will automatically be opened for each cabin for purchases aboard ship. This will include bar services, laundry, postage and communication charges.

If passengers are sharing a cabin and would like separate accounts, they must advise the Hotel Manager immediately. A 'chit' system will operate for on board payments and any bar, wine, communication charges, laundry, etc., should be signed for. An account for payment will be presented on the final day of the voyage.

Final payment can be made using cash, travelers checks or major credit cards - Visa, MasterCard, Diners Club or American Express. All prices are in US dollars. Personal checks are NOT accepted on board.

SHOP/SOUVENIRS

There is no shop on board, however, the bartender will have a limited stock of souvenirs (T-shirts, sweatshirts, caps, stuffed animals, films, drugstore items, sweets, etc.) on sale in the bar. Payment for items purchased can be made by cash, travelers checks or Visa, MasterCard, Diners Club and American Express.

SMOKING

Smoking in public areas is only allowed on the open decks. Smoking is not allowed in the dining room or bar. If passengers have booked on a 'share basis', smoking in the cabin is not allowed unless both passengers agree.

VALUABLES

The vessel has small in-cabin safes on Decks 5 and 6 only. Passengers on Decks 3 and 4 will be provided with a safe deposit envelope in order to store their valuables. This should be given to the Hotel Manager who will keep it in the main safe in his office.

VIDEO SCREENING

A multi-system video recorder and television is available if passengers wish to view their own videos or a selection from the video library.

VIEWING AREAS

Views are excellent from the large open decks and Navigation Bridge. Passengers are welcome nearly everywhere on the ship, including (conditions permitting) the bow and stern.

ZODIACS

The M/V Orlova carries a fleet of sturdy Zodiac craft for leisurely cruising and beach landings.



M/V ORLOVA

Side Plan

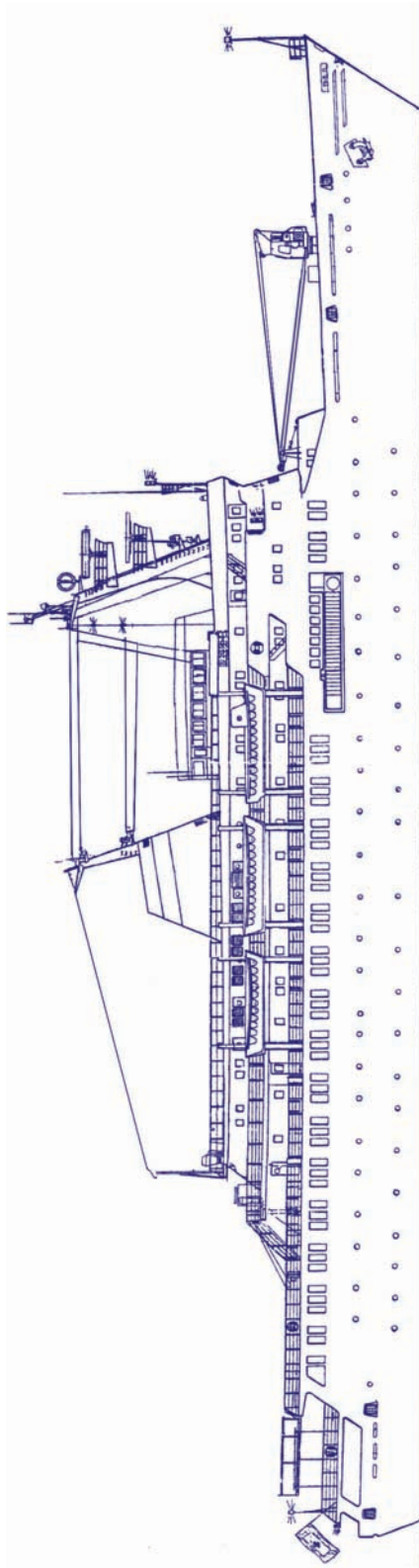



M/V ORLOVA

Deck Plan

Captain's Deck

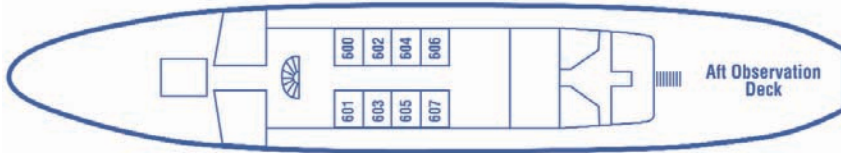

Upper Deck

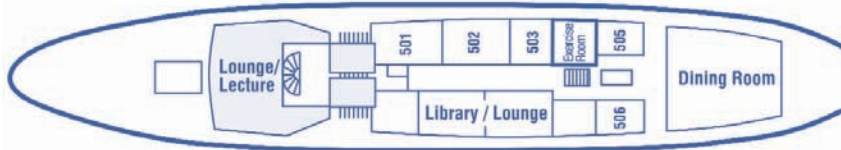

Main Deck

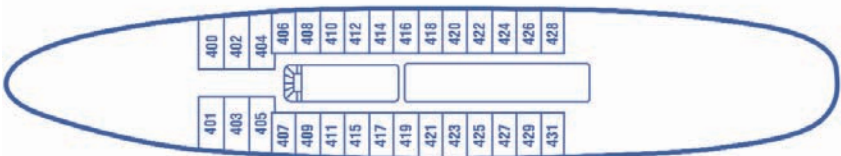

Lower Deck

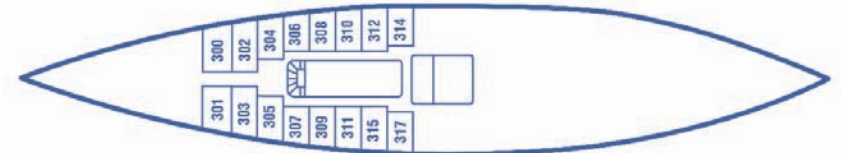

| | |
|-----------------------------|---|
| AMUNDSEN SUITE: | 501; 502 |
| SUPERIOR: | 503; 505; 506 |
| CAPTAIN'S DECK TWIN: | 602; 603; 604; 605; 606; 607 |
| MAIN DECK TWIN: | 407; 408; 409; 410; 411; 412; 414; 415; 417; 418; 419; 420; 421; 422; 423; 424; 425; 426; 427; 428; 429; 431 |
| LOWER DECK TWIN: | 300; 301; 302; 303; 304; 305; 306; 307; 308; 309; 310; 311; 312; 315 |
| TRIPLE: | 400; 401; 402; 403; 404; 405; 416 |
| STAFF CABINS: | 314; 317; 406; 600; 601 |



M/V ORLOVA

Amundsen Suite

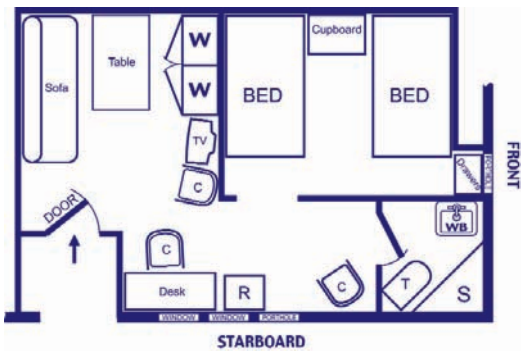
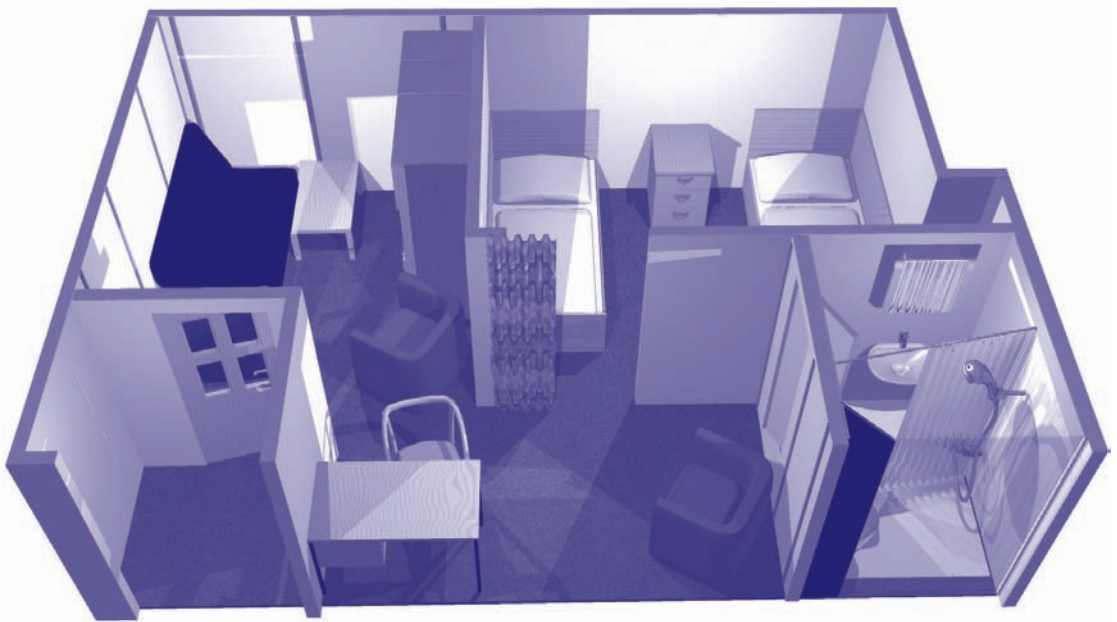

KEY:

- W - Wardrobe
- T - Toilet
- S - Shower
- WB - Wash-basin
- C - Chair
- R - Refrigerator

- 2 CABINS:** 501; 502
- SIZE:** 31 m² \ 333.7 sq ft
Cabin Height 2.1 m \ 3.3 ft
- CABIN:** Standard Beds: 1.92 x 1.04 m \ 6.3 x 3.4 ft
TV
Sofa
Safe
Refrigerator
Electrical Outlets (European) 220Volt/50Hz
Table + Desk
2 Armchairs + 1 Chair
Wardrobe
Locker
Cupboard
Telephone
Air Ventilation
4 Windows/Portholes (2 fixed)
Carpet

- BATHROOM:** Shower
Wash-basin
Hooks
Mirror
Basket
Shelf
Toilet (vacuum system)



M/V ORLOVA

Superior

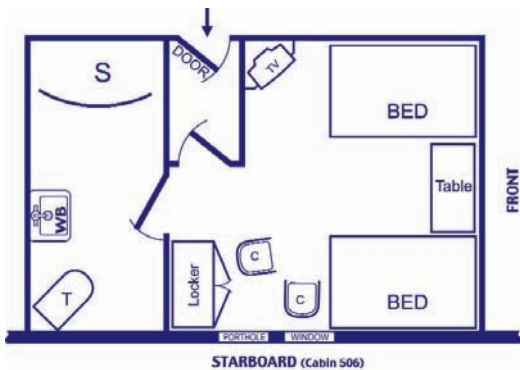
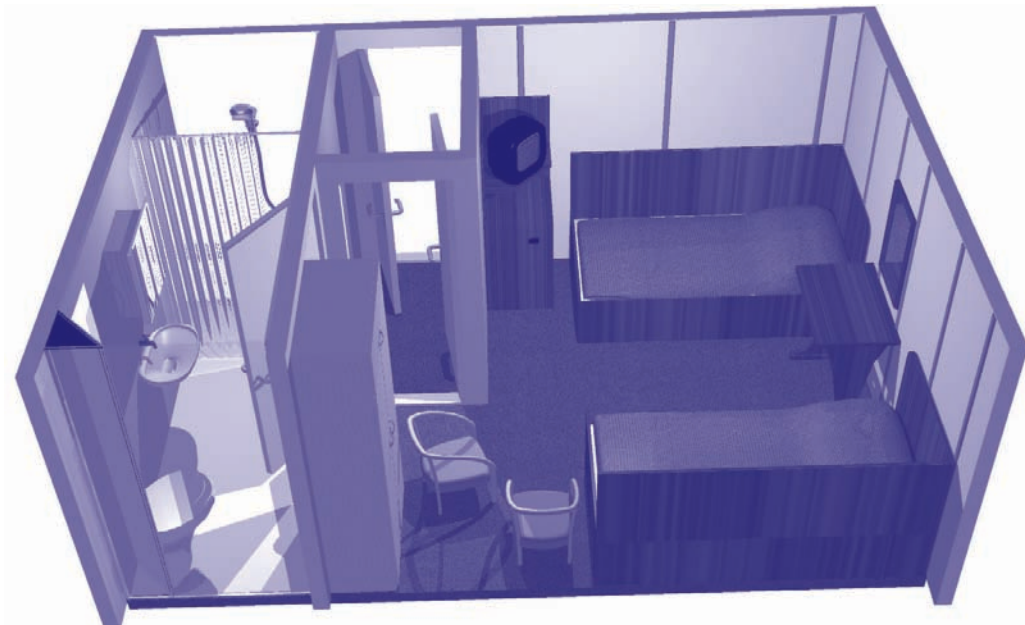

KEY:

- T - Toilet
- S - Shower
- WB - Wash-basin
- C - Chair

3 CABINS: 503, 505, 506

SIZE: 11.9 m² \ 128 sq ft
Cabin Height 2.1 m \ 3.3 ft

CABIN: Standard Beds: 2.02 m x 1.02 m \ 6.6 x 3.3 ft
TV
Safe
Electrical Outlets (European) 220Volt/50Hz
Table
2 Chairs
Locker
Telephone
Air Ventilation
2 Windows/Portholes
Mirror
Carpet

BATHROOM: Shower
Wash-basin
Hooks
Mirror
Basket
Shelf
Toilet (vacuum system)



M/V ORLOVA

Captain's Deck Twin Cabin

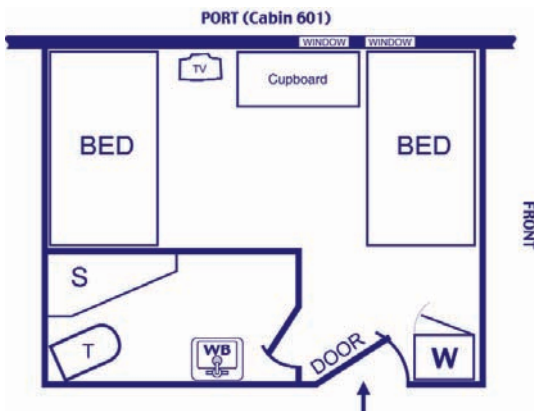

KEY:
 W - Wardrobe
 T - Toilet
 S - Shower
 WB - Wash-basin

8 CABINS: 602; 603; 604; 605; 606; 607

SIZE: 10.2m² \ 110.2sq ft
 Cabin Height 1.97m \ 6.5ft

CABIN: 2 Lower Berths: 1.9 x 0.75 m \ 6.2 X 2.5 ft
 Safe
 TV
 Electrical Outlets (Europeans) 220Volt/50Hz
 Wardrobe
 Cupboard
 Chair
 Mirror
 Telephone
 Air Ventilation
 2 Windows/Portholes
 Carpet

BATHROOM: Shower
 Wash-basin
 Hooks
 Mirror
 Basket
 Shelf
 Toilet (Vacuum System)



M/V ORLOVA

Main Deck Twin Cabin

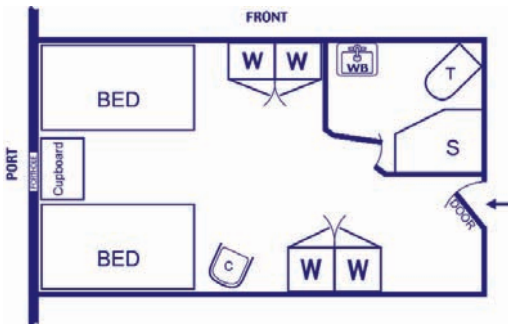
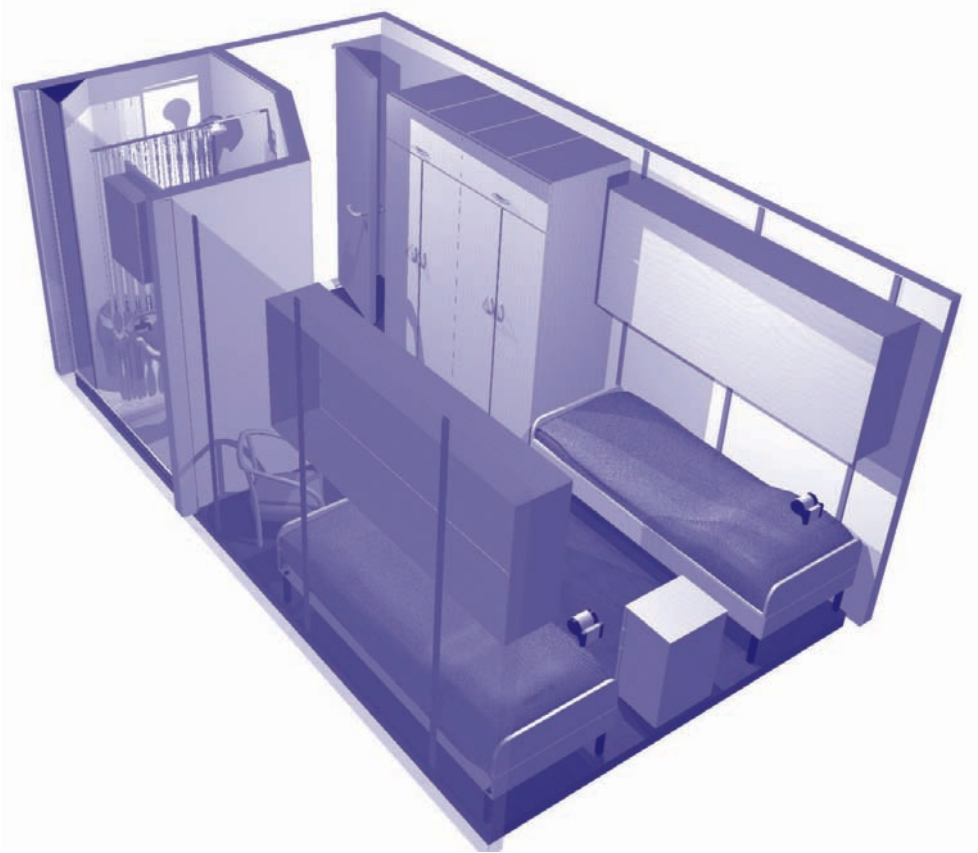

KEY:

- W - Wardrobe
- T - Toilet
- S - Shower
- WB - Wash-basin
- C - Chair

23 CABINS: 407; 408; 409; 410; 411; 412; 414; 415; 417; 418; 419; 420; 421; 422; 423; 424; 425; 426; 427; 428; 429; 431

SIZE: 11.8 m² \ 127 sq ft
Cabin Height 2.1 m \ 3.3 ft

CABIN: 2 Lower Berths: 1.9 x 0.75 m \ 6.2 X 2.5 ft
Electrical Outlets (European) 220Volt/50Hz
Chair
2 Wardrobes
Cupboard
Telephone
Air Ventilation
Window/Porthole (not to be opened)
Mirror
Carpet

BATHROOM: Shower
Wash-basin
Hooks
Mirror
Basket
Shelf
Toilet (Vacuum System)



M/V ORLOVA

Lower Deck Twin Cabin

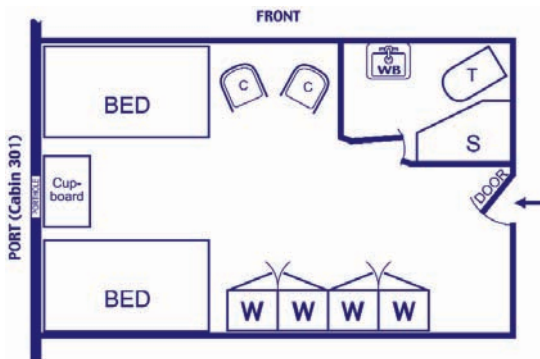

KEY:

- W - Wardrobe
- T - Toilet
- S - Shower
- WB - Wash-basin
- C - Chair

14 CABINS: 300; 301; 302; 303; 304; 305; 306; 307; 308;309; 310; 311; 312; 315

SIZE: 14.8 m² \ 159.3 sq ft
Cabin Height 2.1 m \ 3.3 ft

CABIN: 2 Lower Berths: 1.9 x 0.75 m \ 6.2 X 2.5 ft
Electrical Outlets (European) 220Volt/50Hz
2 Chairs
2 Wardrobes
Cupboard
2 Storage Boxes
Telephone
Air Ventilation
Window/Porthole (not to be opened)
Mirror
Carpet

BATHROOM: Shower
Wash-basin
Hooks
Mirror
Basket
Shelf
Toilet (vacuum system)



M/V ORLOVA

Triple Cabin

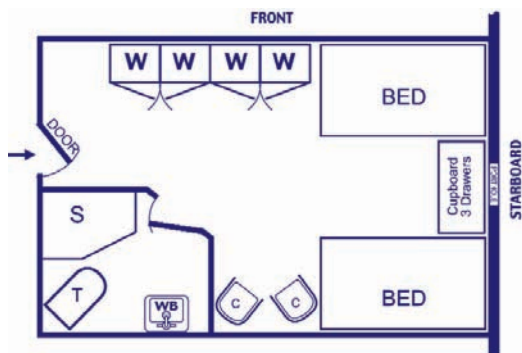
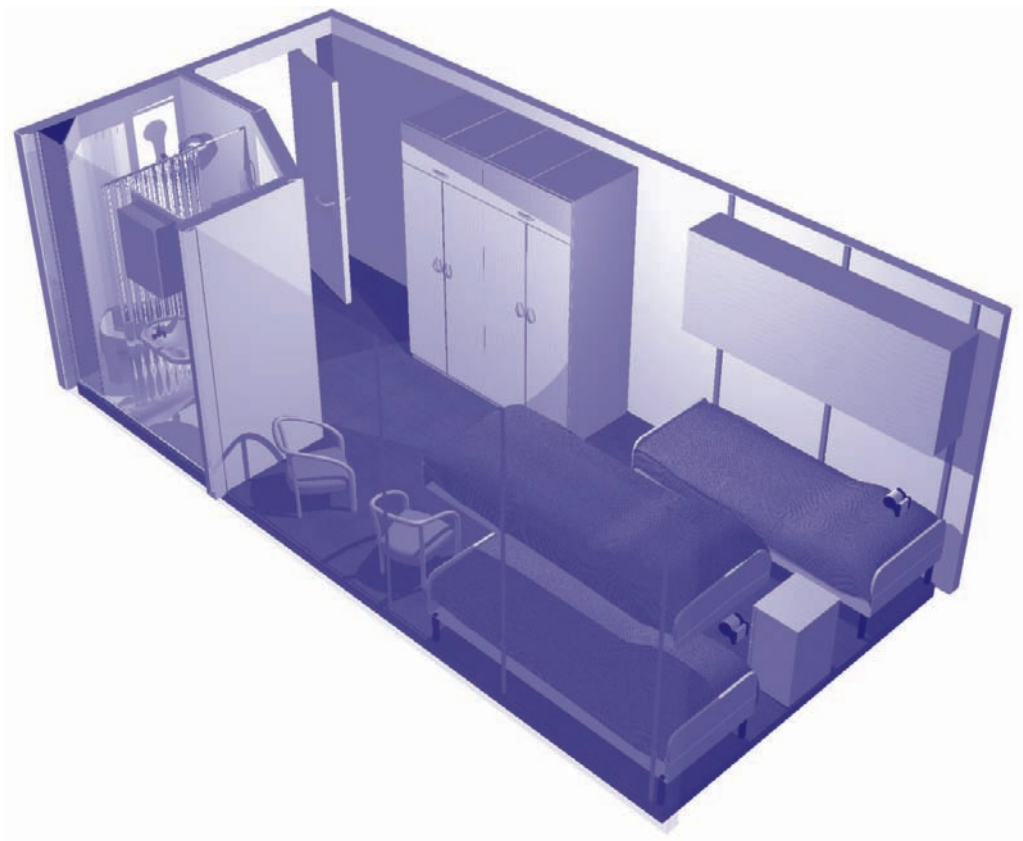

KEY:

- W - Wardrobe
- T - Toilet
- S - Shower
- WB - Wash-basin
- C - Chair

- 7 CABINS:** 400; 401; 402; 403; 404; 405; 416
- SIZE:** 16.75m² \ 180.3sq ft
Cabin Height 2.1m \ 3.3ft
- CABIN:**
 - 2 Lower Berths: 1.9 x 0.75 m \ 6.2 X 2.5 ft
 - 1 Upper Berth: 1.9 x 0.75 m \ 6.2 X 2.5 ft
 - Electrical Outlets (European) 220Volt/50Hz
 - 2 Chairs
 - 3 Wardrobes
 - Cupboard
 - Telephone
 - Air Ventilation
 - Window/Porthole (not to be opened)
 - Mirror
 - Carpet
- BATHROOM:**
 - Shower
 - Wash-basin
 - Hooks
 - Mirror
 - Basket
 - Shelf
 - Toilet (vacuum system)

US Office:

Quark Expeditions Inc.,
980 Post Road,
Darien, CT 06820, USA
Tel: 203-656-0499
Fax: 203-655-6623
Toll Free: 800-356-5699
enquiry@quarkexpeditions.com

UK Office:

Quark Expeditions (UK) Limited,
19A Crendon Street,
High Wycombe, Bucks HP13 6LJ,
United Kingdom
Tel: +44 (1494) 464080
Fax: +44 (1494) 449739
enquiry@quarkexpeditions.co.uk

www.quarkexpeditions.com

DISCLAIMER: All details are correct at time of production. However Quark Expeditions reserves the right to revise specifications at any time. Cabin plans show the average look of a cabin in each category and should be used as a guide only. Cabin allocations, specifications and layouts are subject to change without any notice.